

PDF PAGE	CSA PAGE	CONTENTS	SYNC MASTER	DATE
2	2	H5P JTAG, USB ,PLL	N/A	N/A
3	3	H5P GPIO & CONTROL	N/A	N/A
4	4	H5P IO POWER	N/A	N/A
5	5	H5P SOC/CPU/SRAM PWR	N/A	N/A
6	6	H5P W/ NAND	N/A	N/A
7	7	H5P VIDEO	N/A	N/A
8	8	BUTTON FLEX B2B	N/A	N/A
9	9	L81 AUDIO CODEC	N/A	N/A
10	10	CG FLEX B2B	N/A	N/A
11	12	AGATHA PMU(1/2)	N/A	N/A
12	13	AGATHA PMU(2/2)	N/A	N/A
13	14	CHESTNUT + BACKLIGHT DRIVER	N/A	N/A
14	15	SPKR AMP + LED DRIVER	N/A	N/A
15	16	TRISTAR	N/A	N/A
16	17	DOCKFLEX B2B	N/A	N/A
17	18	D404 (TOUCH B2B, DRIVER ICS)	N/A	N/A
18	19	LCM CONNECTOR	N/A	N/A
19	20	OSCAR + SENSORS	N/A	N/A
20	21	CAM0 CONNECTOR	N/A	N/A
21	22	BATT B2B, TPS, PD FEATURES	N/A	N/A
22	23	RADIO_MLB HIERARCH. SYMBOL	N/A	N/A

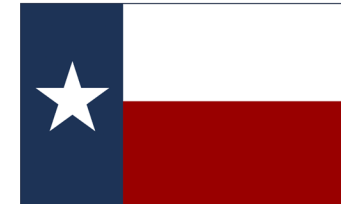

iPhone 5C Schematics

Dewatermarked &
Released Free
From Texas with Love.

SCH 051-0143
BRD 820-3581

BOM 639-4501

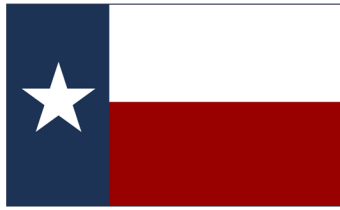

iPhone 5C Schematics

Dewatermarked &
Released Free
From Texas with Love.

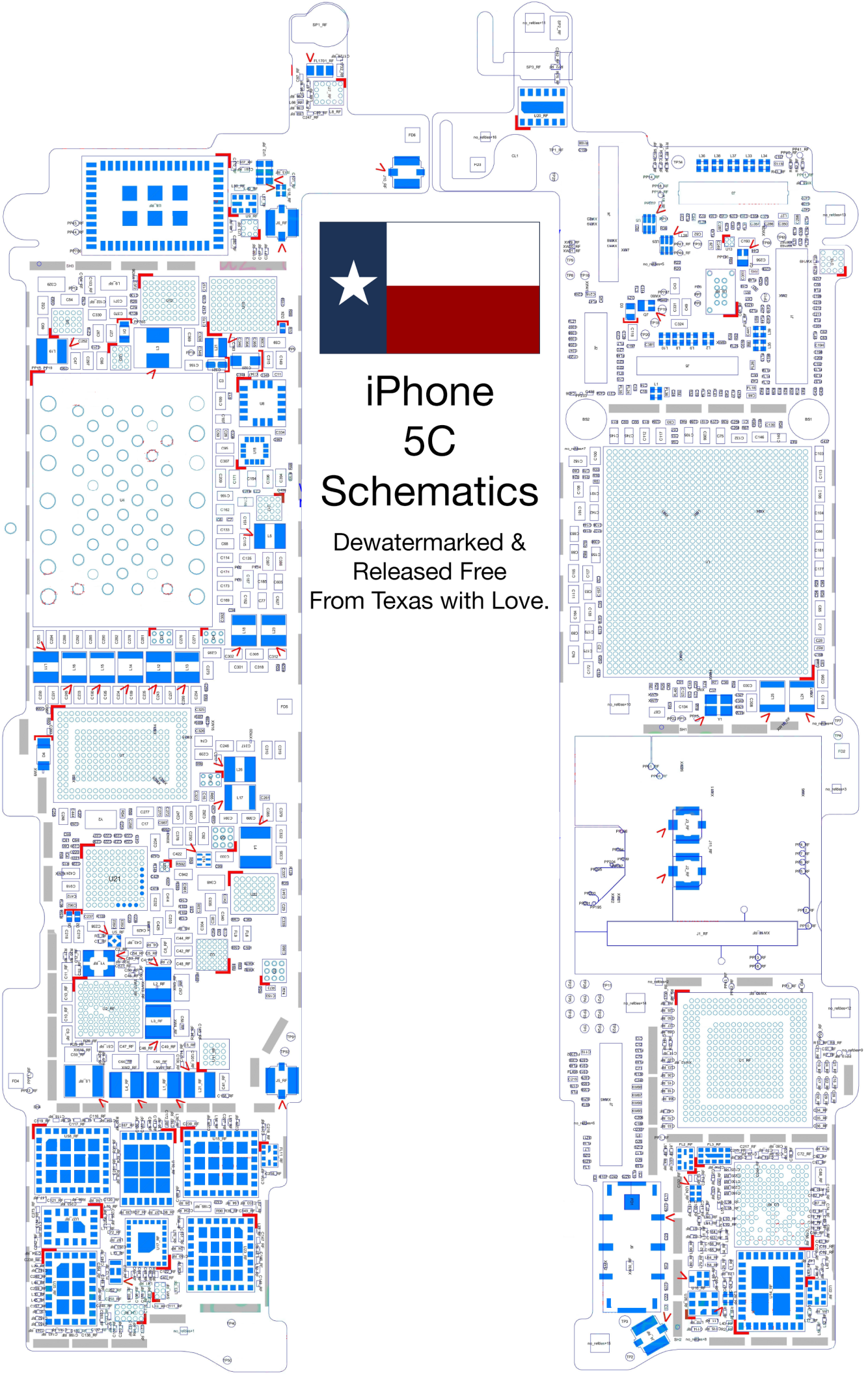

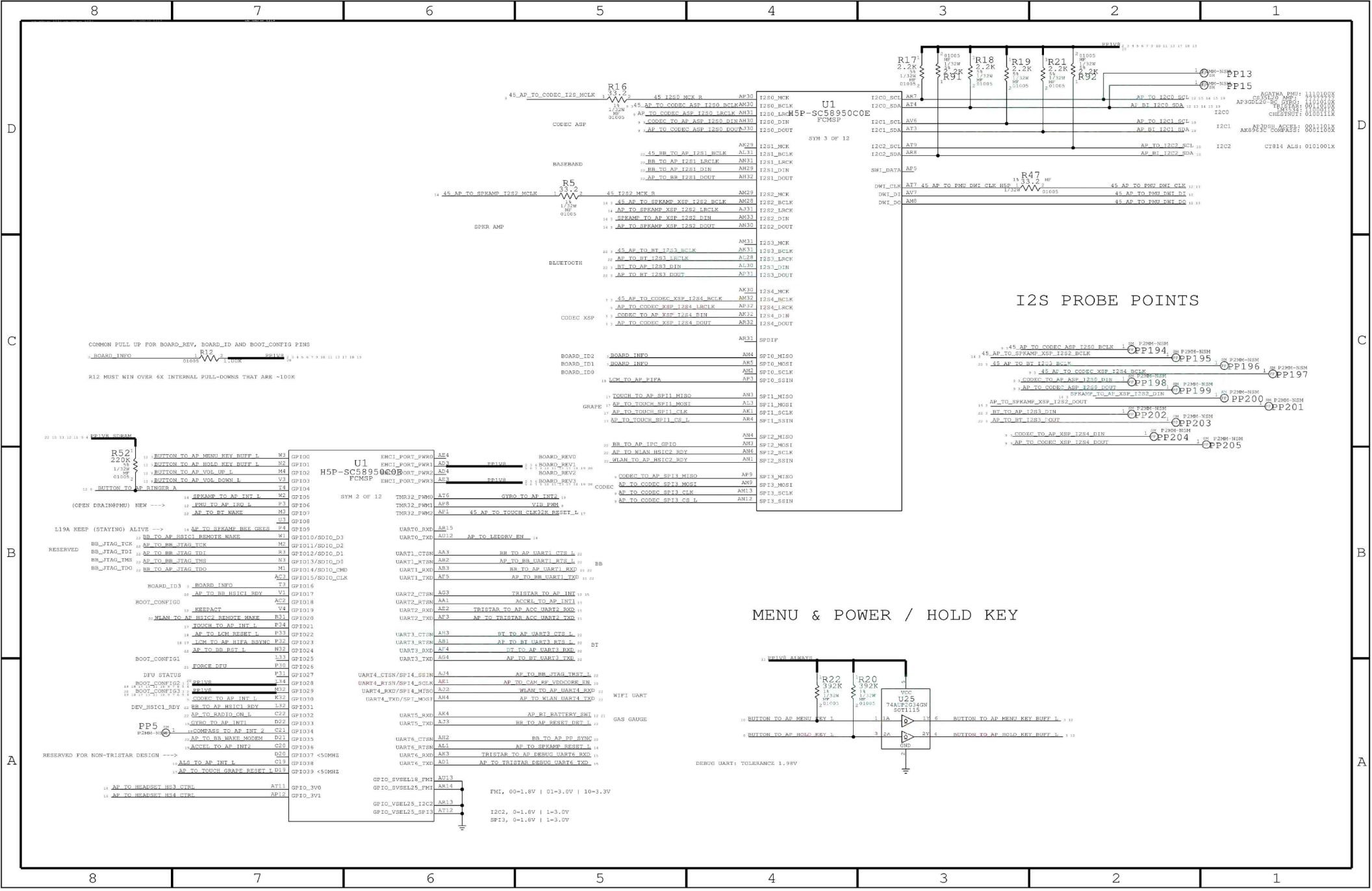

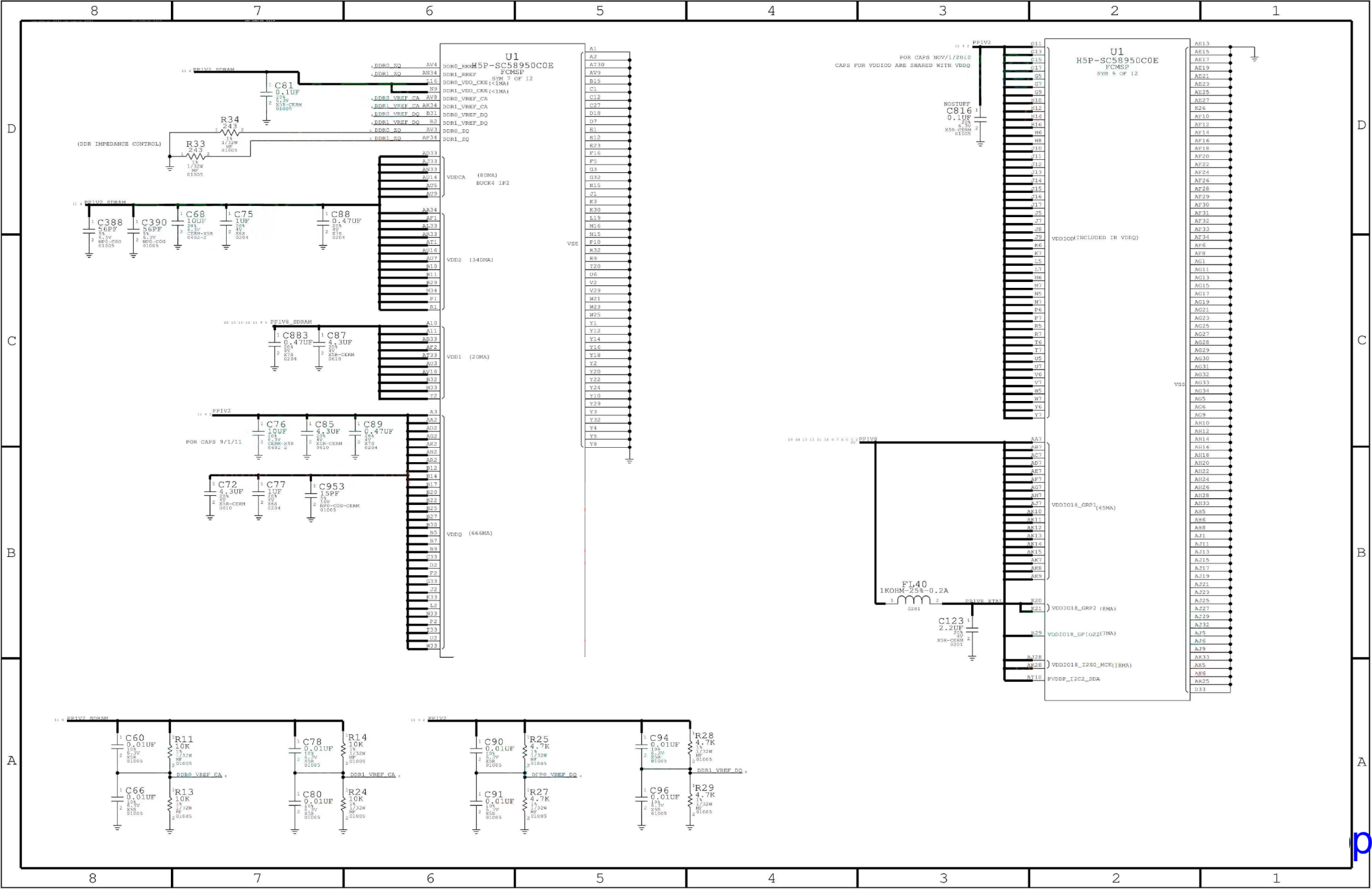

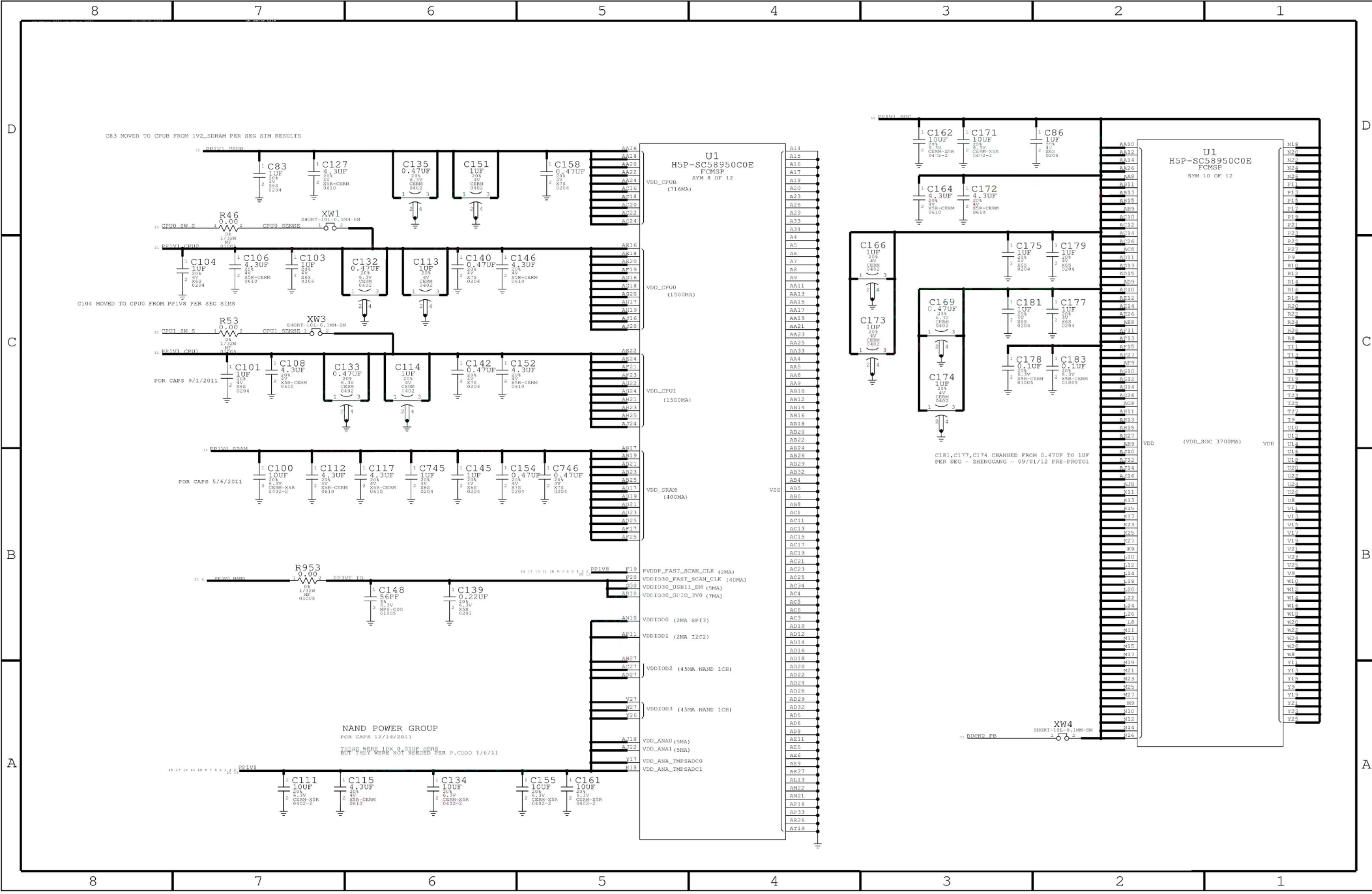

NAND

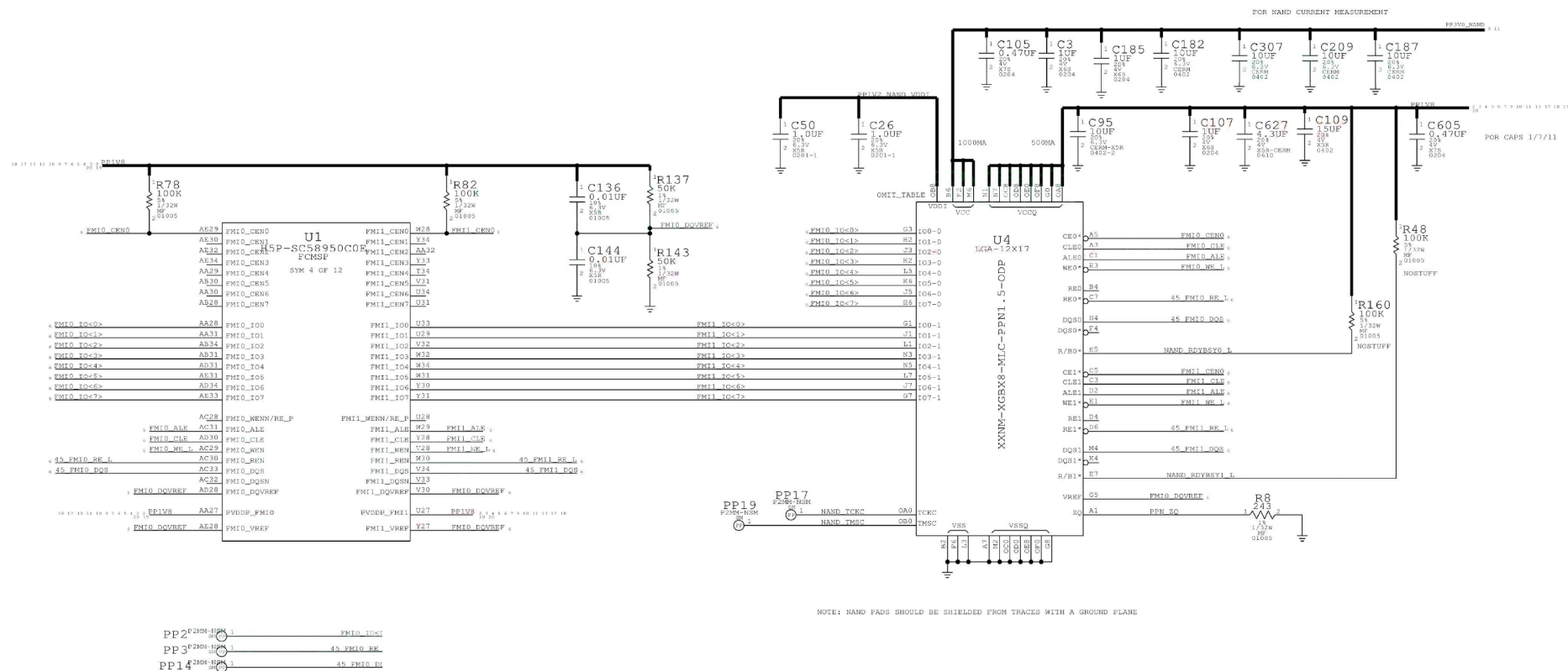

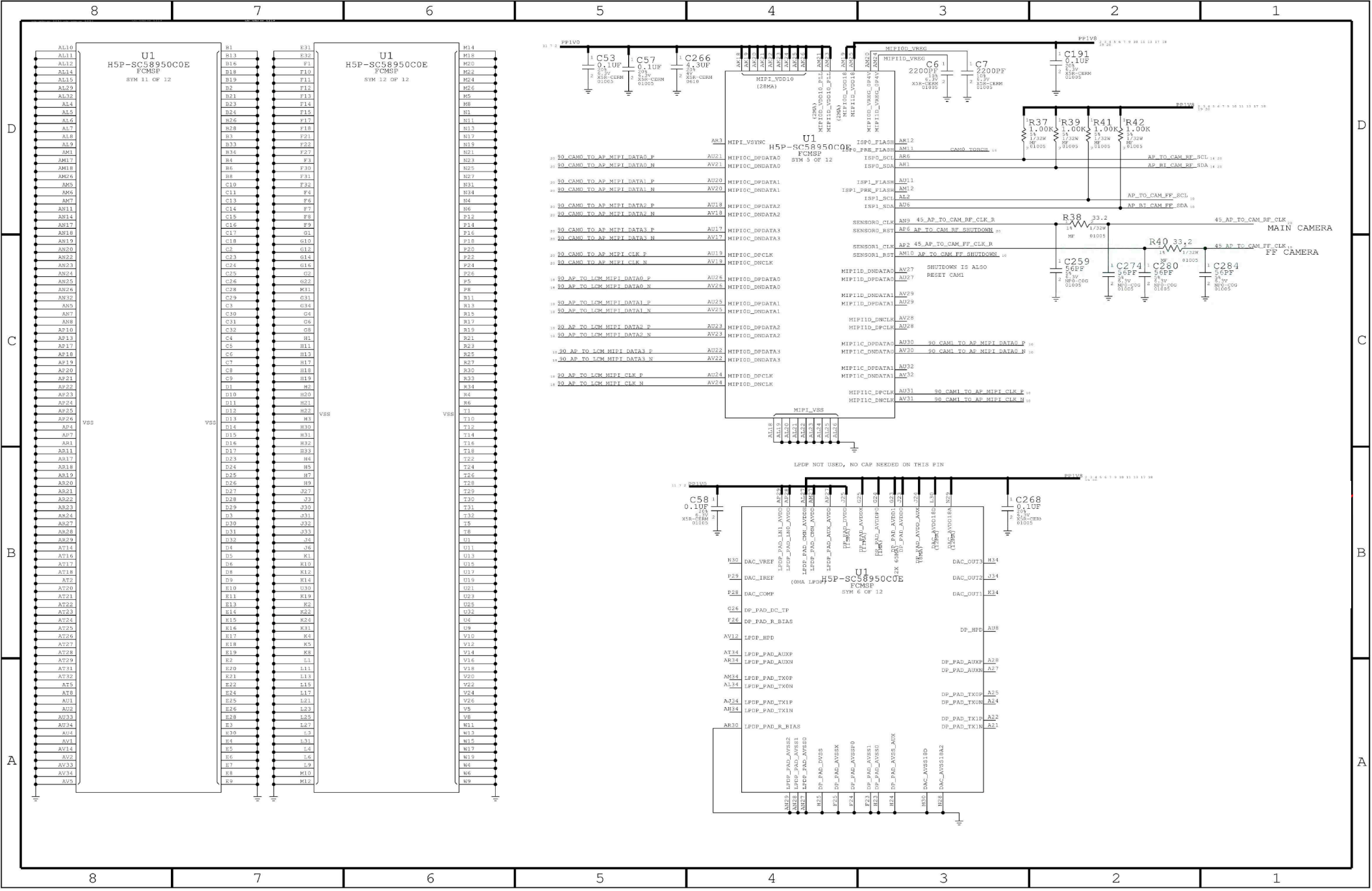

8
 7
 6
 5
 4
 3
 2
 1

BUTTON FLEX (VIBE DRIVER, BUTTONS, ANC REF MIC, STROBE, STROBE_NTC)

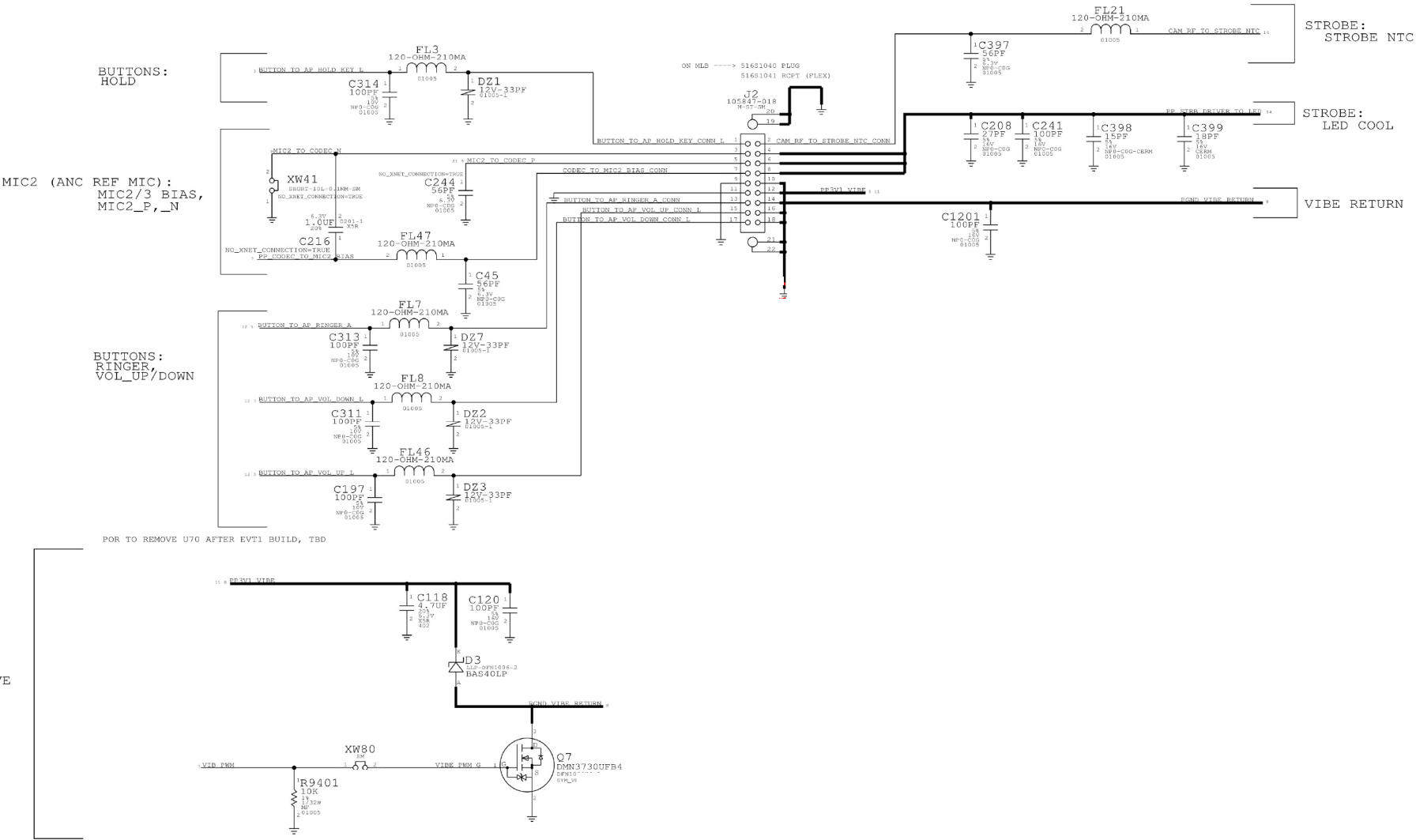

POWER, MICBIAS

DIGITAL SYSTEM I/O

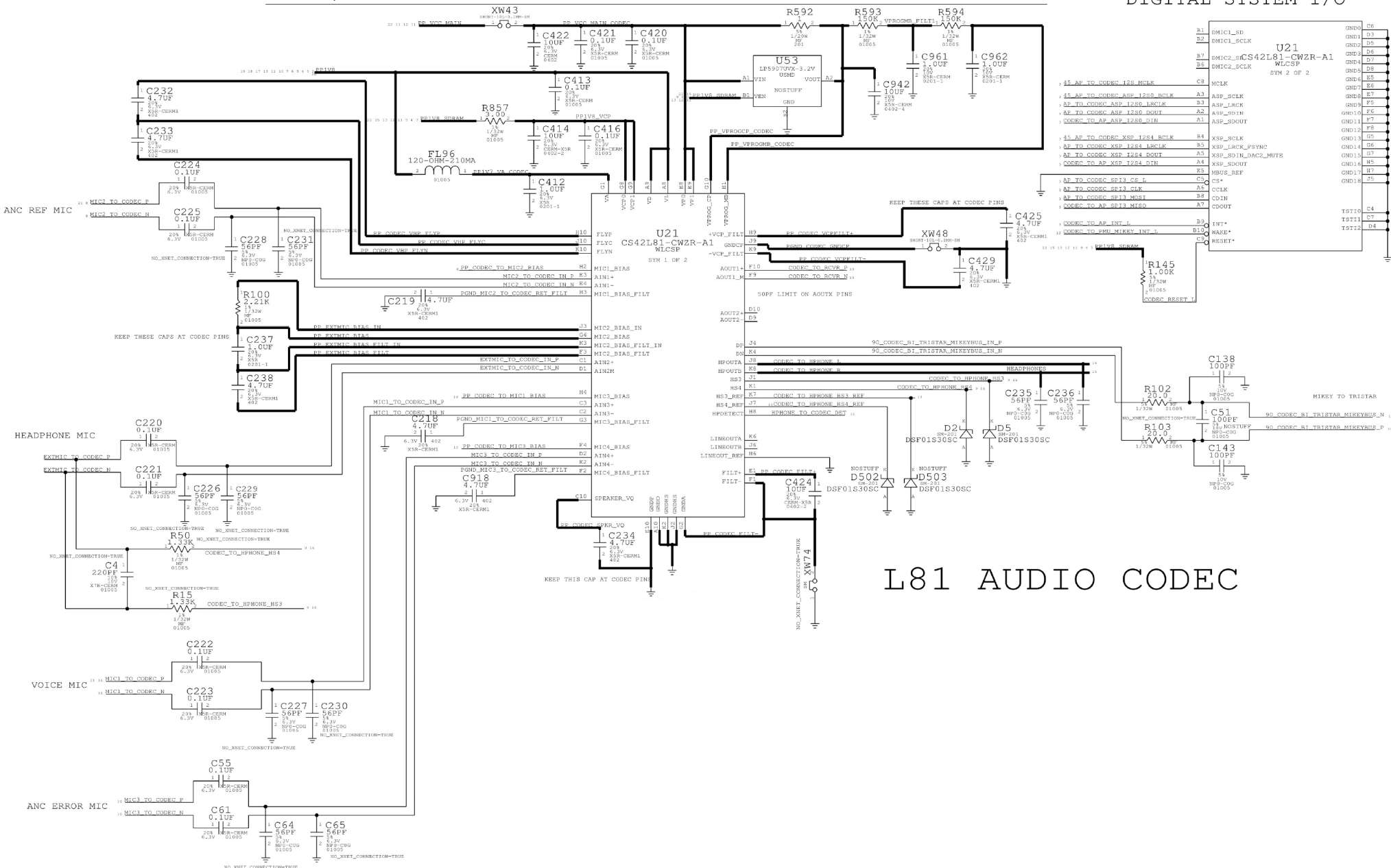

(FE CAM, PROX, ALS, RECEIVER, ANC ERROR MIC)

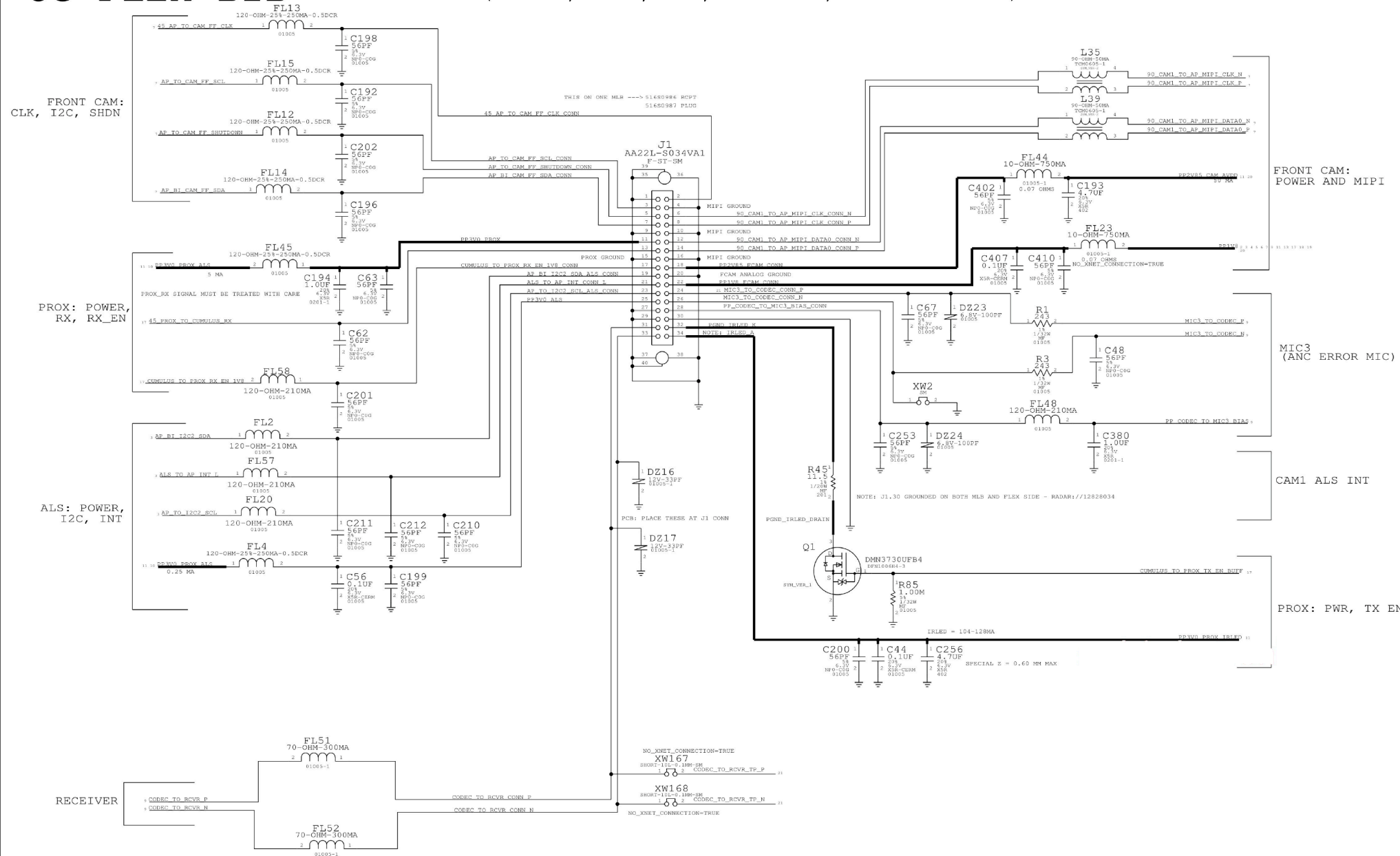

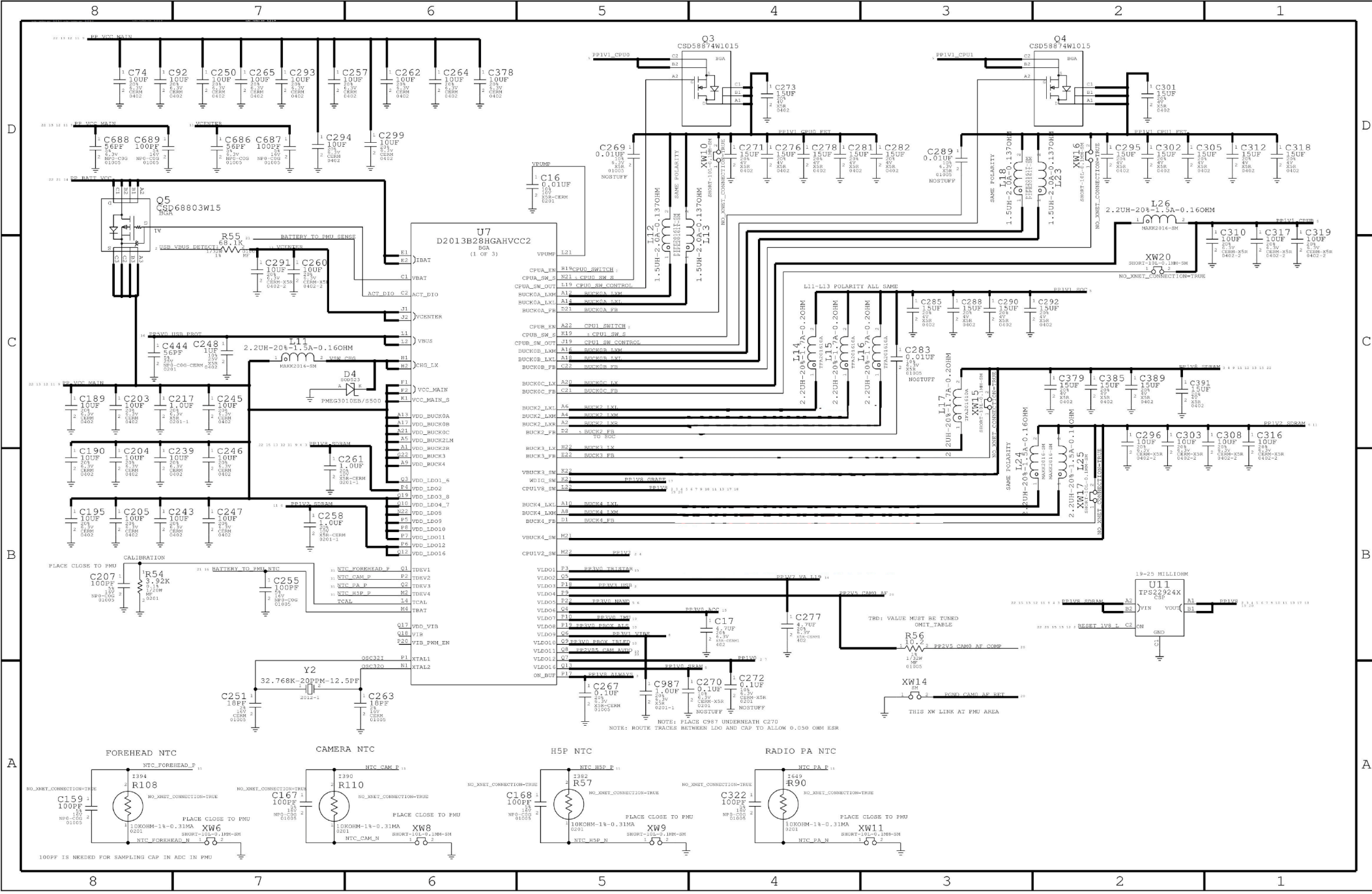

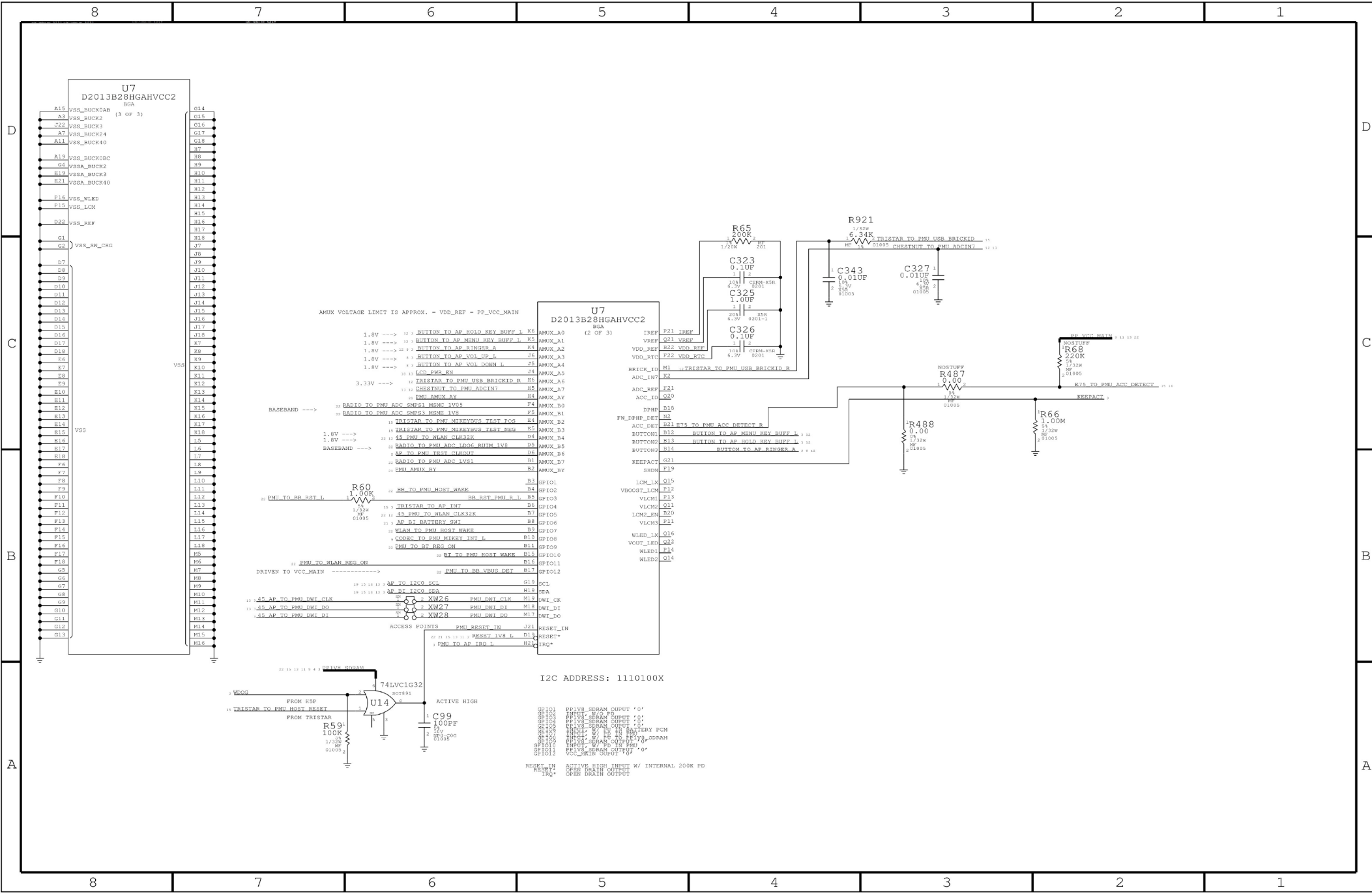

CHESTNUT, BACKLIGHT DRIVER

D404 DISPLAY PMU (INTERSIL CHESTNUT, 338S1168)
(TI CHESTNUT, 338S1172)

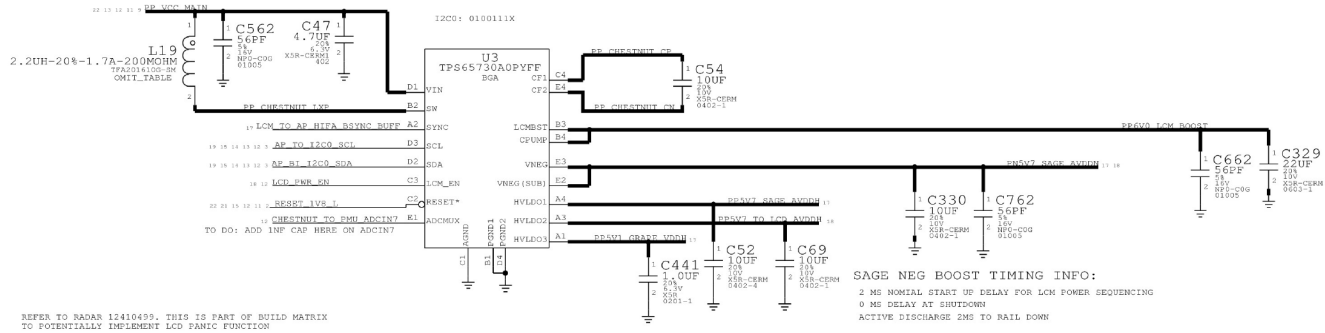

D404 BACKLIGHT DRIVER

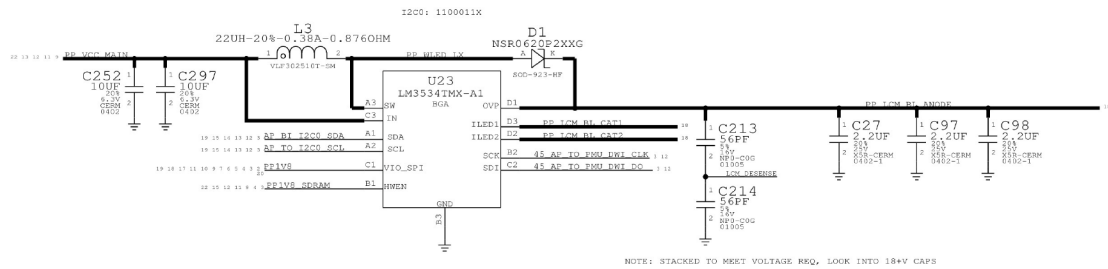

SPEAKER AMP, LED DRIVER

SPEAKER AMP L19

I2C ADDRESS: 1000000X

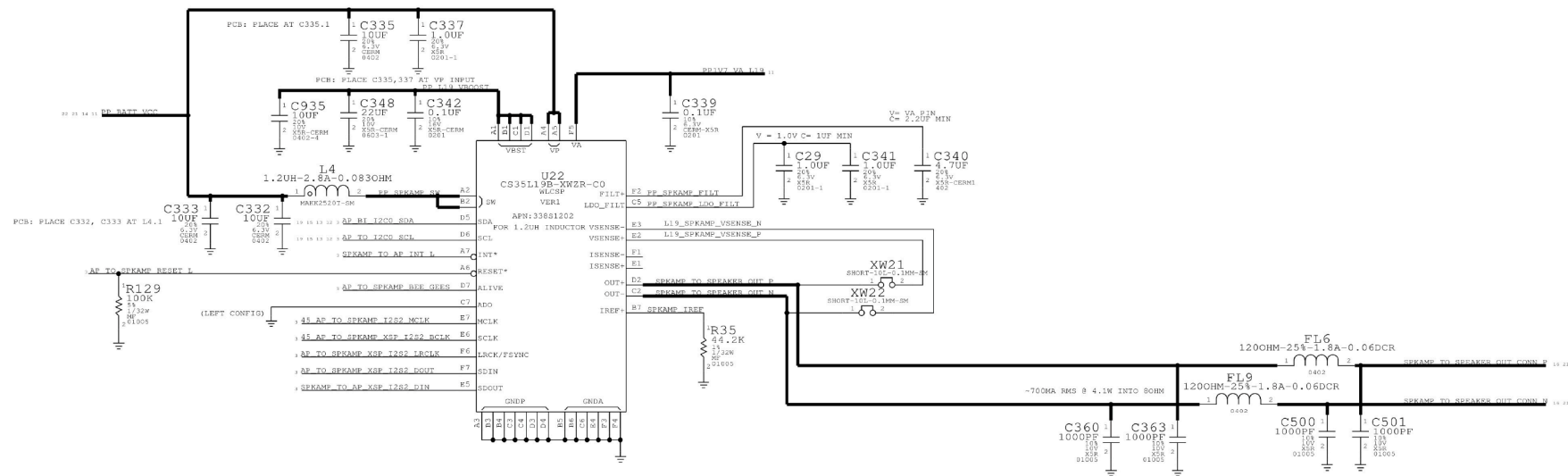

LED DRIVER

I2C ADDRESS: 1100011X

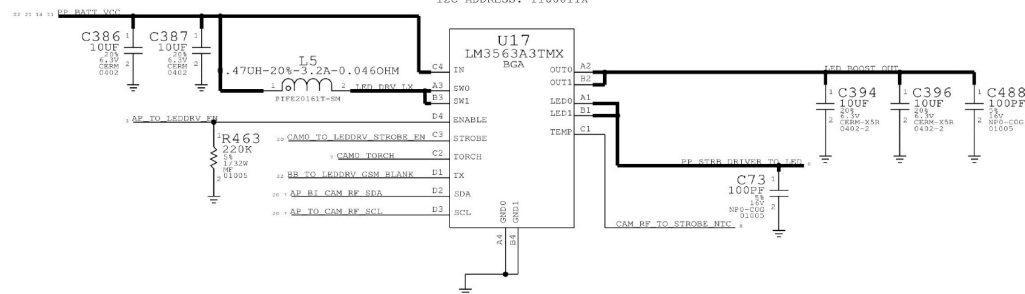

[illegible]

DOCKFLEX B2B (USB VBUS, MENU BTN, SPEAKER, HP, HP EXTMIC, NAVAJO, ANTENNA PAC/LAT SW CTRL, MIC1 (VOICE MIC), ACC DET/ID/PWR, E75 DIFFPAIRS)

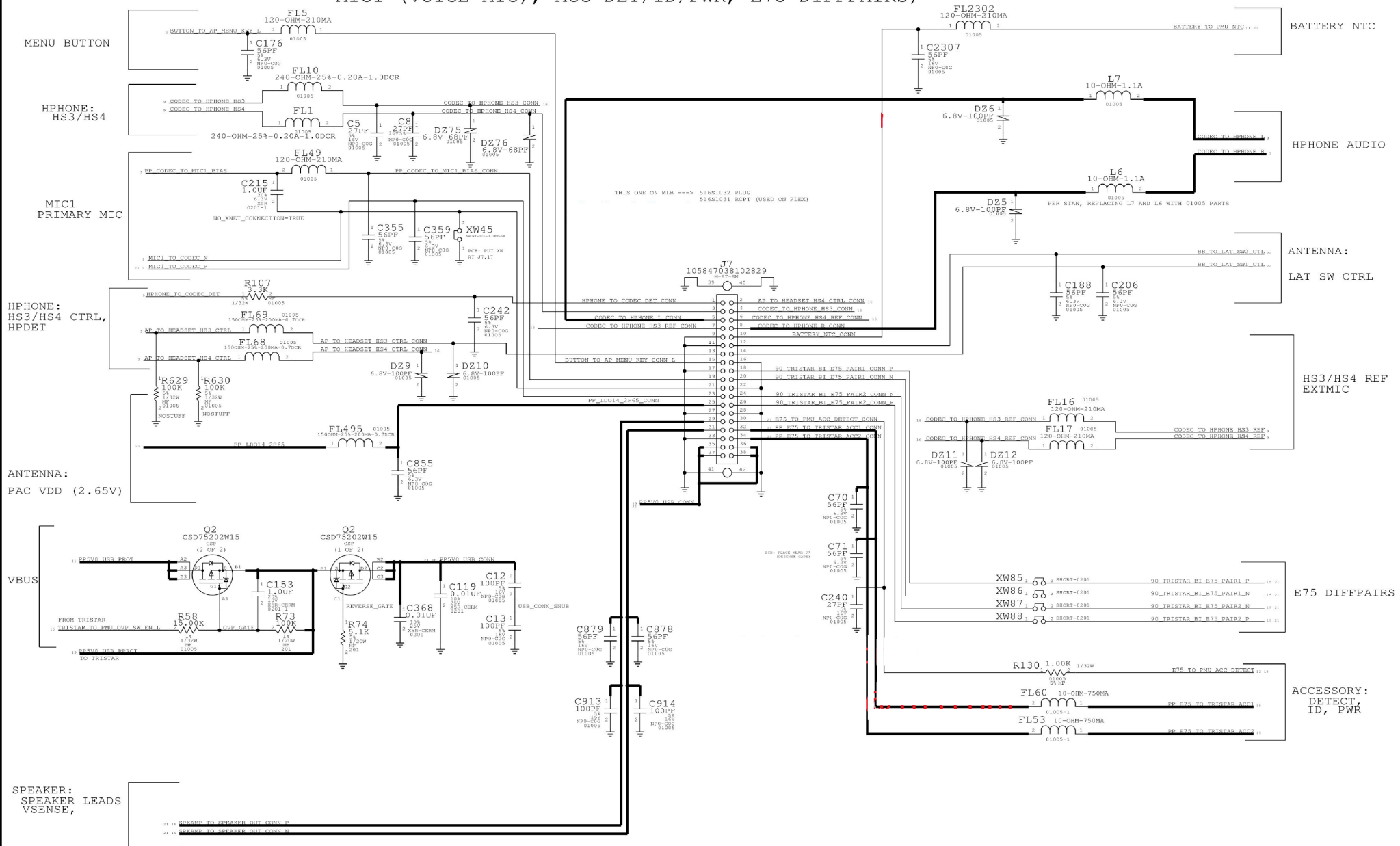

LCM B2B

LCM CONNECTOR

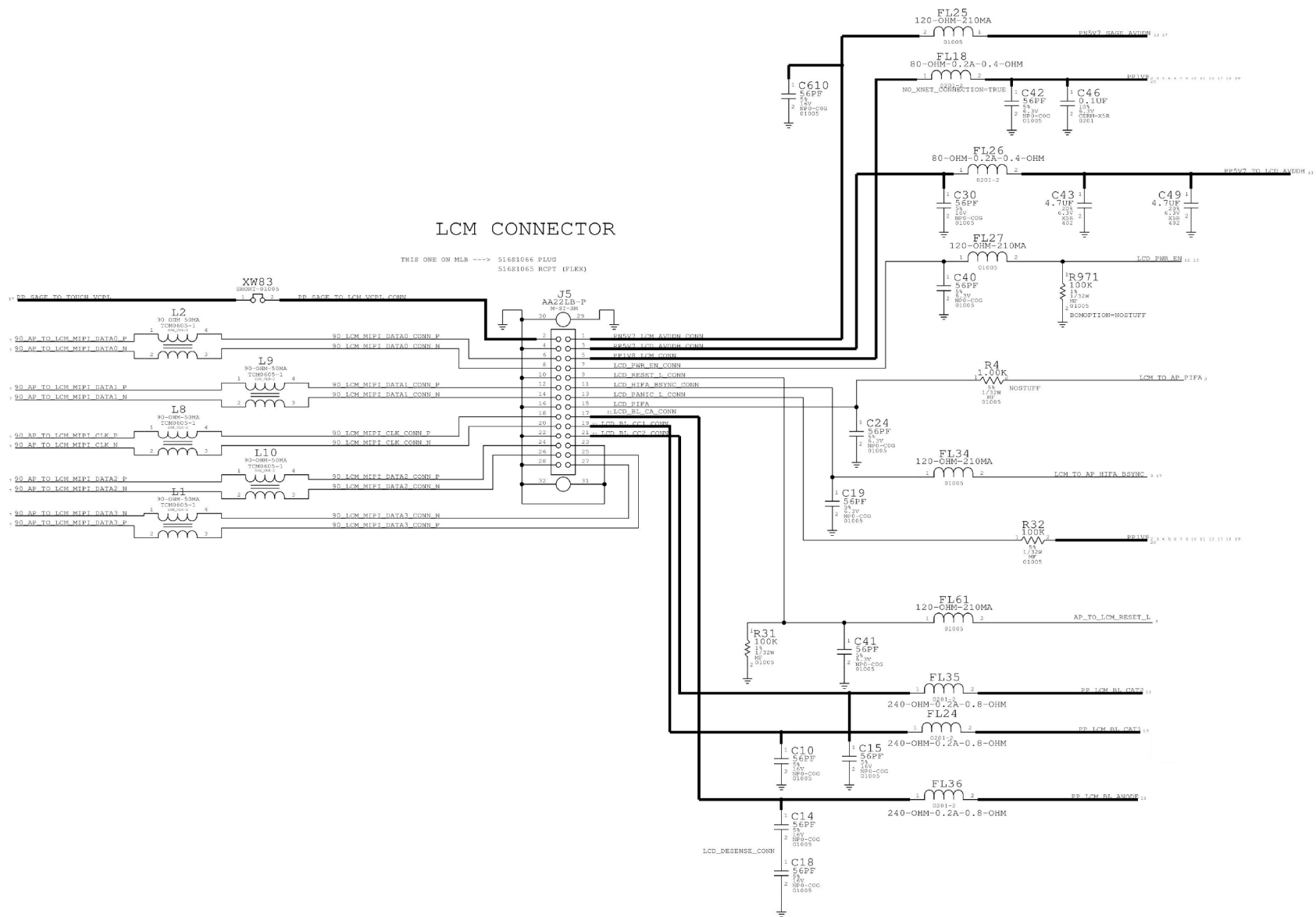

SENSORS

THIS PART OUTSIDE OF SHIELD

COMPASS

COMPASS DEVICE: 338S1014
COMPASS INTERPOSER: 998-5120

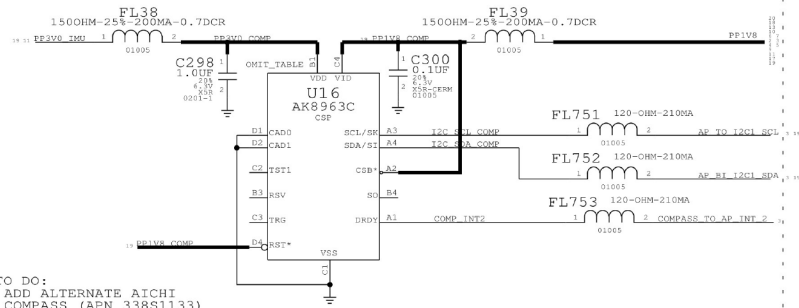

THESE PARTS INSIDE OF SHIELD

GYRO

AP3GDL20HAB, APN 338S1192

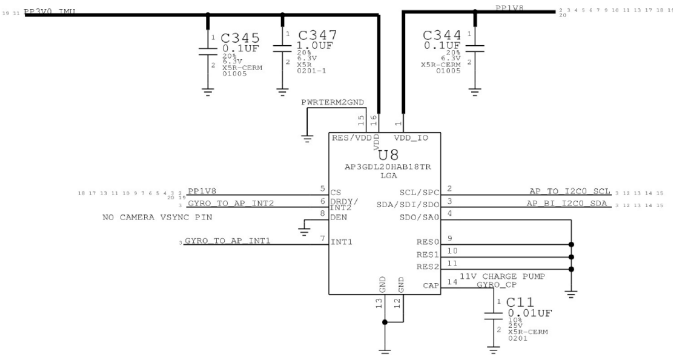

ACCELEROMETER

AP2DHAB, APN 338S1191

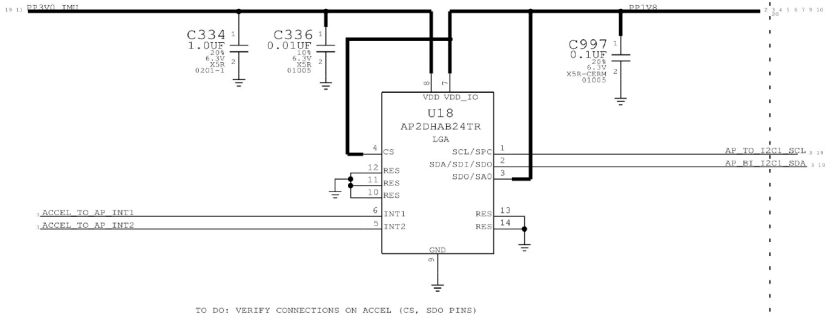

CAM0: MAIN CAMERA CONNECTOR

